



PULEGGE PER CINGHIE DENTATE PASSO METRICO ST PER CINGHIE «AT»

ST Timing belt pulleys metric pitch for «AT» belts
ST Zahnriemenscheiben metrische Teilung für «AT» riemen
Poulies dentées ST pour courroies «AT» pas métrique
Poleas dentadas ST para correas «AT» con paso metrico

Pulegge per cinghie dentate passo metrico ST per cinghie "AT" ST Timing belt pulleys metric pitch for "AT" belts ST Zahnriemenscheiben metrische Teilung für "AT" Riemen Poulies dentées ST pour courroies "AT" pas métrique Poleas dentadas ST para correas "AT" con paso metrico

Materiale:
alluminio 6082 T6
UNI 9006/4 adatto al
trattamento anodico

Material:
aluminium 6082 T6
UNI 9006/4 suitable for
anodic treatment

Werkstoff:
Aluminium 6082 T6
UNI 9006/4 geeignet für
anodischen oxydation

Matière:
aluminium 6082 T6
UNI 9006/4 apte au
traitement anodique

Material:
aluminio 6082 T6
UNI 9006/4 apto para la
oxidacion anodica

Tipo / Type
6F

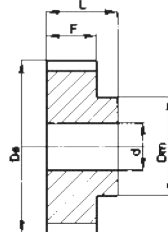
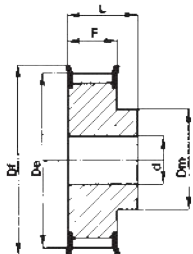

Tipo / Type
6

ST 5

(Passo 5 mm)
per cinghia larghezza 10 mm

(Pitch 5 mm)
for belt width 10 mm

(Teilung 5 mm)
für Riemenbreite 10 mm

(Pas 5 mm)
pour courroies largeur 10 mm

(Paso 5 mm)
para correas ancho 10 mm

| Code Code symbol / Bezeichnung Code symbole / Numero de fabrica | Nostro codice Our code / Unser Code Notre code / Nuestro codigo | Tipo Type / Typ Type / Tipo | Codice flangia Flange code / Bordscheiben Typ Code flasque / Código brida | N. denti N. of teeth / Zähnezahl N. bre de dents / Cantidad de dientes | Dp | De | Df | Dm | F | L | d | Peso / Weight Gewicht / Poids / Peso Kg |
|---|---|-----------------------------------|---|---|-------|-------|------|----|----|----|---|---|
| 21 ST5/12-2 | 21ST512 | 6F | FL001 | 12 | 19,10 | 17,85 | 23,0 | 11 | 15 | 21 | 4 | 0,018 |
| 21 ST5/14-2 | 21ST514 | 6F | FL002 | 14 | 22,29 | 21,05 | 25,0 | 13 | 15 | 21 | 4 | 0,019 |
| 21 ST5/15-2 | 21ST515 | 6F | FL004 | 15 | 23,88 | 22,65 | 28,0 | 16 | 15 | 21 | 6 | 0,021 |
| 21 ST5/16-2 | 21ST516 | 6F | FL005 | 16 | 25,47 | 24,20 | 32,0 | 18 | 15 | 21 | 6 | 0,025 |
| 21 ST5/18-2 | 21ST518 | 6F | FL006 | 18 | 28,65 | 27,40 | 32,0 | 20 | 15 | 21 | 6 | 0,031 |
| 21 ST5/19-2 | 21ST519 | 6F | FL008 | 19 | 30,25 | 29,00 | 36,0 | 22 | 15 | 21 | 6 | 0,036 |
| 21 ST5/20-2 | 21ST520 | 6F | FL008 | 20 | 31,83 | 30,60 | 36,0 | 23 | 15 | 21 | 6 | 0,038 |
| 21 ST5/22-2 | 21ST522 | 6F | FL009 | 22 | 35,02 | 33,85 | 38,0 | 24 | 15 | 21 | 6 | 0,048 |
| 21 ST5/24-2 | 21ST524 | 6F | FL013 | 24 | 38,21 | 37,00 | 42,0 | 26 | 15 | 21 | 6 | 0,054 |
| 21 ST5/25-2 | 21ST525 | 6F | FL012 | 25 | 39,80 | 38,60 | 44,0 | 26 | 15 | 21 | 6 | 0,058 |
| 21 ST5/26-2 | 21ST526 | 6F | FL012 | 26 | 41,39 | 40,20 | 44,0 | 26 | 15 | 21 | 6 | 0,062 |
| 21 ST5/27-2 | 21ST527 | 6F | FL011 | 27 | 42,98 | 41,80 | 48,0 | 30 | 15 | 21 | 8 | 0,064 |
| 21 ST5/28-2 | 21ST528 | 6F | FL011 | 28 | 44,58 | 43,35 | 48,0 | 32 | 15 | 21 | 8 | 0,071 |
| 21 ST5/30-2 | 21ST530 | 6F | FL016 | 30 | 47,76 | 46,55 | 51,0 | 34 | 15 | 21 | 8 | 0,076 |
| 21 ST5/32-2 | 21ST532 | 6F | FL018 | 32 | 50,94 | 49,70 | 54,0 | 36 | 15 | 21 | 8 | 0,088 |
| 21 ST5/36-2 | 21ST536 | 6F | FL023 | 36 | 57,31 | 56,05 | 64,0 | 38 | 15 | 21 | 8 | 0,114 |
| 21 ST5/40-2 | 21ST540 | 6F | FL024 | 40 | 63,66 | 62,45 | 66,5 | 40 | 15 | 21 | 8 | 0,138 |
| 21 ST5/42-2 | 21ST542 | 6F | FL026 | 42 | 66,86 | 65,60 | 70,0 | 40 | 15 | 21 | 8 | 0,180 |
| 21 ST5/44-0 | 21ST544 | 6 | - | 44 | 70,05 | 68,80 | - | 45 | 15 | 21 | 8 | 0,185 |
| 21 ST5/48-0 | 21ST548 | 6 | - | 48 | 76,42 | 75,15 | - | 50 | 15 | 21 | 8 | 0,200 |
| 21 ST5/60-0 | 21ST560 | 6 | - | 60 | 95,52 | 94,25 | - | 65 | 15 | 21 | 8 | 0,307 |

(Passo 5 mm)
per cinghia larghezza 16 mm

(Pitch 5 mm)
for belt width 16 mm

(Teilung 5 mm)
für Riemenbreite 16 mm

(Pas 5 mm)
pour courroies largeur 16 mm

(Paso 5 mm)
para correas ancho 16 mm

| | | | | | | | | | | | | |
|-------------|---------|----|-------|----|-------|-------|------|----|----|----|---|-------|
| 27 ST5/12-2 | 27ST512 | 6F | FL001 | 12 | 19,10 | 17,85 | 23,0 | 11 | 21 | 27 | 4 | 0,022 |
| 27 ST5/14-2 | 27ST514 | 6F | FL002 | 14 | 22,29 | 21,05 | 25,0 | 13 | 21 | 27 | 4 | 0,026 |
| 27 ST5/15-2 | 27ST515 | 6F | FL004 | 15 | 23,88 | 22,65 | 28,0 | 16 | 21 | 27 | 6 | 0,029 |
| 27 ST5/16-2 | 27ST516 | 6F | FL005 | 16 | 25,47 | 24,20 | 32,0 | 18 | 21 | 27 | 6 | 0,035 |
| 27 ST5/18-2 | 27ST518 | 6F | FL006 | 18 | 28,65 | 27,40 | 32,0 | 20 | 21 | 27 | 6 | 0,043 |
| 27 ST5/19-2 | 27ST519 | 6F | FL008 | 19 | 30,25 | 29,00 | 36,0 | 22 | 21 | 27 | 6 | 0,049 |
| 27 ST5/20-2 | 27ST520 | 6F | FL008 | 20 | 31,83 | 30,60 | 36,0 | 23 | 21 | 27 | 6 | 0,053 |
| 27 ST5/22-2 | 27ST522 | 6F | FL009 | 22 | 35,02 | 33,85 | 38,0 | 24 | 21 | 27 | 6 | 0,054 |
| 27 ST5/24-2 | 27ST524 | 6F | FL013 | 24 | 38,21 | 37,00 | 42,0 | 26 | 21 | 27 | 6 | 0,076 |
| 27 ST5/25-2 | 27ST525 | 6F | FL012 | 25 | 39,80 | 38,60 | 44,0 | 26 | 21 | 27 | 6 | 0,081 |
| 27 ST5/26-2 | 27ST526 | 6F | FL012 | 26 | 41,39 | 40,20 | 44,0 | 26 | 21 | 27 | 6 | 0,085 |
| 27 ST5/27-2 | 27ST527 | 6F | FL011 | 27 | 42,98 | 41,80 | 48,0 | 30 | 21 | 27 | 8 | 0,090 |
| 27 ST5/28-2 | 27ST528 | 6F | FL011 | 28 | 44,58 | 43,35 | 48,0 | 32 | 21 | 27 | 8 | 0,092 |
| 27 ST5/30-2 | 27ST530 | 6F | FL016 | 30 | 47,76 | 46,55 | 51,0 | 34 | 21 | 27 | 8 | 0,105 |
| 27 ST5/32-2 | 27ST532 | 6F | FL018 | 32 | 50,94 | 49,70 | 54,0 | 36 | 21 | 27 | 8 | 0,123 |
| 27 ST5/36-2 | 27ST536 | 6F | FL023 | 36 | 57,31 | 56,05 | 64,0 | 38 | 21 | 27 | 8 | 0,160 |
| 27 ST5/40-2 | 27ST540 | 6F | FL024 | 40 | 63,66 | 62,45 | 66,5 | 40 | 21 | 27 | 8 | 0,193 |
| 27 ST5/42-2 | 27ST542 | 6F | FL026 | 42 | 66,86 | 65,60 | 70,0 | 40 | 21 | 27 | 8 | 0,205 |
| 27 ST5/44-0 | 27ST544 | 6 | - | 44 | 70,05 | 68,80 | - | 45 | 21 | 27 | 8 | 0,228 |
| 27 ST5/48-0 | 27ST548 | 6 | - | 48 | 76,42 | 75,15 | - | 50 | 21 | 27 | 8 | 0,280 |
| 27 ST5/60-0 | 27ST560 | 6 | - | 60 | 95,52 | 94,25 | - | 65 | 21 | 27 | 8 | 0,430 |

(Passo 5 mm)
per cinghia larghezza 25 mm

(Pitch 5 mm)
for belt width 25 mm

(Teilung 5 mm)
für Riemenbreite 25 mm

(Pas 5 mm)
pour courroies largeur 25 mm

(Paso 5 mm)
para correas ancho 25 mm

| | | | | | | | | | | | | |
|-------------|---------|----|-------|----|-------|-------|------|----|----|----|---|-------|
| 36 ST5/12-2 | 36ST512 | 6F | FL001 | 12 | 19,10 | 17,85 | 23,0 | 11 | 30 | 36 | 4 | 0,031 |
| 36 ST5/14-2 | 36ST514 | 6F | FL002 | 14 | 22,29 | 21,05 | 25,0 | 13 | 30 | 36 | 4 | 0,037 |
| 36 ST5/15-2 | 36ST515 | 6F | FL004 | 15 | 23,88 | 22,65 | 28,0 | 16 | 30 | 36 | 6 | 0,041 |
| 36 ST5/16-2 | 36ST516 | 6F | FL005 | 16 | 25,47 | 24,20 | 32,0 | 18 | 30 | 36 | 6 | 0,050 |
| 36 ST5/18-2 | 36ST518 | 6F | FL006 | 18 | 28,65 | 27,40 | 32,0 | 20 | 30 | 36 | 6 | 0,061 |
| 36 ST5/19-2 | 36ST519 | 6F | FL008 | 19 | 30,25 | 29,00 | 36,0 | 22 | 30 | 36 | 6 | 0,070 |
| 36 ST5/20-2 | 36ST520 | 6F | FL008 | 20 | 31,83 | 30,60 | 36,0 | 23 | 30 | 36 | 6 | 0,076 |
| 36 ST5/22-2 | 36ST522 | 6F | FL009 | 22 | 35,02 | 33,85 | 38,0 | 24 | 30 | 36 | 6 | 0,080 |
| 36 ST5/24-2 | 36ST524 | 6F | FL013 | 24 | 38,21 | 37,00 | 42,0 | 26 | 30 | 36 | 6 | 0,109 |
| 36 ST5/25-2 | 36ST525 | 6F | FL012 | 25 | 39,80 | 38,60 | 44,0 | 26 | 30 | 36 | 6 | 0,118 |
| 36 ST5/26-2 | 36ST526 | 6F | FL012 | 26 | 41,39 | 40,20 | 44,0 | 26 | 30 | 36 | 6 | 0,120 |
| 36 ST5/27-2 | 36ST527 | 6F | FL011 | 27 | 42,98 | 41,80 | 48,0 | 30 | 30 | 36 | 8 | 0,128 |
| 36 ST5/28-2 | 36ST528 | 6F | FL011 | 28 | 44,58 | 43,35 | 48,0 | 32 | 30 | 36 | 8 | 0,135 |
| 36 ST5/30-2 | 36ST530 | 6F | FL016 | 30 | 47,76 | 46,55 | 51,0 | 34 | 30 | 36 | 8 | 0,150 |
| 36 ST5/32-2 | 36ST532 | 6F | FL018 | 32 | 50,94 | 49,70 | 54,0 | 36 | 30 | 36 | 8 | 0,178 |
| 36 ST5/36-2 | 36ST536 | 6F | FL023 | 36 | 57,31 | 56,05 | 64,0 | 38 | 30 | 36 | 8 | 0,230 |
| 36 ST5/40-2 | 36ST540 | 6F | FL024 | 40 | 63,66 | 62,45 | 66,5 | 40 | 30 | 36 | 8 | 0,278 |
| 36 ST5/42-2 | 36ST542 | 6F | FL026 | 42 | 66,86 | 65,60 | 70,0 | 40 | 30 | 36 | 8 | 0,284 |
| 36 ST5/44-0 | 36ST544 | 6 | - | 44 | 70,05 | 68,80 | - | 45 | 30 | 36 | 8 | 0,315 |
| 36 ST5/48-0 | 36ST548 | 6 | - | 48 | 76,42 | 75,15 | - | 50 | 30 | 36 | 8 | 0,400 |
| 36 ST5/60-0 | 36ST560 | 6 | - | 60 | 95,52 | 94,25 | - | 65 | 30 | 36 | 8 | 0,614 |

Pullege per cinghie dentate passo metrico ST per cinghie "AT"
ST Timing belt pulleys metric pitch for "AT" belts
ST Zahnriemenscheiben metrische Teilung für "AT" Riemen
Poulies dentées ST pour courroies "AT" pas métrique
Poleas dentadas ST para correas "AT" con paso metrico



Materiale:
alluminio 6082 T6
UNI 9006/4 adatto al
trattamento anodico

Material:
aluminium 6082 T6
UNI 9006/4 suitable for
anodic treatment

Werkstoff:
Aluminium 6082 T6
UNI 9006/4 geeignet für
anodischen oxydation

Matière:
aluminium 6082 T6
UNI 9006/4 apte au
traitement anodique

Material:
aluminio 6082 T6
UNI 9006/4 apto para la
oxidacion anodica

Tipo / Type
6F

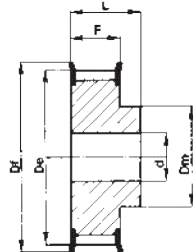

Tipo / Type
6

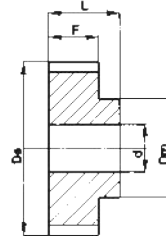

ST 10

(Passo 10 mm)
 per cinghia larghezza 16 mm

(Pitch 10 mm)
 for belt width 16 mm

(Teilung 10 mm)
 für Riemenbreite 16 mm

(Pas 10 mm)
 pour courroies largeur 16 mm

(Paso 10 mm)
 para correas ancho 16 mm

| Codice Code symbol / Bezeichnung Code symbole / Numero de fabrica | Nostro codice Our code / Unser Code Notre code / Nuestro codigo | Tipo Type / Typ Type / Tipo | Codice flangia Flange code / Bordscheiben Typ Code flasque / Código brida | N. denti N. of teeth / Zähnezahl N. bre de dents / Cantidad de dientes | Dp | De | Df | Dm | F | L | d | Peso / Weight Gewicht / Poids / Peso Kg |
|---|---|-----------------------------------|---|---|--------|--------|-------|-----|----|----|----|---|
| 31 ST10/15-2 | 31ST115 | 6F | FL016 | 15 | 47,75 | 45,90 | 51,0 | 31 | 21 | 31 | 8 | 0,118 |
| 31 ST10/16-2 | 31ST116 | 6F | FL018 | 16 | 50,93 | 49,05 | 54,0 | 35 | 21 | 31 | 8 | 0,134 |
| 31 ST10/18-2 | 31ST118 | 6F | FL021 | 18 | 57,29 | 55,45 | 60,0 | 40 | 21 | 31 | 8 | 0,167 |
| 31 ST10/19-2 | 31ST119 | 6F | FL024 | 19 | 60,48 | 58,60 | 66,5 | 44 | 21 | 31 | 8 | 0,184 |
| 31 ST10/20-2 | 31ST120 | 6F | FL024 | 20 | 63,66 | 61,80 | 66,5 | 46 | 21 | 31 | 8 | 0,208 |
| 31 ST10/22-2 | 31ST122 | 6F | FL027 | 22 | 70,03 | 68,15 | 75,0 | 52 | 21 | 31 | 8 | 0,253 |
| 31 ST10/24-2 | 31ST124 | 6F | FL029 | 24 | 76,39 | 74,55 | 83,0 | 58 | 21 | 31 | 8 | 0,288 |
| 31 ST10/25-2 | 31ST125 | 6F | FL029 | 25 | 79,58 | 77,70 | 83,0 | 60 | 21 | 31 | 8 | 0,310 |
| 31 ST10/26-2 | 31ST126 | 6F | FL031 | 26 | 82,76 | 80,90 | 87,0 | 60 | 21 | 31 | 8 | 0,357 |
| 31 ST10/27-2 | 31ST127 | 6F | FL032 | 27 | 85,95 | 84,10 | 91,0 | 60 | 21 | 31 | 8 | 0,364 |
| 31 ST10/28-2 | 31ST128 | 6F | FL033 | 28 | 89,12 | 87,25 | 93,0 | 60 | 21 | 31 | 8 | 0,401 |
| 31 ST10/30-2 | 31ST130 | 6F | FL035 | 30 | 95,49 | 93,65 | 97,0 | 60 | 21 | 31 | 8 | 0,441 |
| 31 ST10/32-2 | 31ST132 | 6F | FL038 | 32 | 101,86 | 100,00 | 106,0 | 65 | 21 | 31 | 10 | 0,493 |
| 31 ST10/36-2 | 31ST136 | 6F | FL043 | 36 | 114,59 | 112,75 | 119,0 | 70 | 21 | 31 | 10 | 0,623 |
| 31 ST10/40-2 | 31ST140 | 6F | FL047 | 40 | 127,32 | 125,45 | 131,0 | 80 | 21 | 31 | 10 | 0,787 |
| 31 ST10/44-0 | 31ST144 | 6 | - | 44 | 140,05 | 138,20 | - | 88 | 21 | 31 | 10 | 0,993 |
| 31 ST10/48-0 | 31ST148 | 6 | - | 48 | 152,78 | 150,95 | - | 95 | 21 | 31 | 16 | 1,090 |
| 31 ST10/60-0 | 31ST160 | 6 | - | 60 | 190,98 | 189,10 | - | 110 | 21 | 31 | 16 | 1,701 |

(Passo 10 mm)
 per cinghia larghezza 25 mm

(Pitch 10 mm)
 for belt width 25 mm

(Teilung 10 mm)
 für Riemenbreite 25 mm

(Pas 10 mm)
 pour courroies largeur 25 mm

(Paso 10 mm)
 para correas ancho 25 mm

| | | | | | | | | | | | | |
|--------------|---------|----|-------|----|--------|--------|-------|-----|----|----|----|-------|
| 40 ST10/15-2 | 40ST115 | 6F | FL016 | 15 | 47,75 | 45,90 | 51,0 | 31 | 30 | 40 | 8 | 0,152 |
| 40 ST10/16-2 | 40ST116 | 6F | FL018 | 16 | 50,93 | 49,05 | 54,0 | 35 | 30 | 40 | 8 | 0,176 |
| 40 ST10/18-2 | 40ST118 | 6F | FL021 | 18 | 57,29 | 55,45 | 60,0 | 40 | 30 | 40 | 8 | 0,224 |
| 40 ST10/19-2 | 40ST119 | 6F | FL024 | 19 | 60,48 | 58,60 | 66,5 | 44 | 30 | 40 | 8 | 0,247 |
| 40 ST10/20-2 | 40ST120 | 6F | FL024 | 20 | 63,66 | 61,80 | 66,5 | 46 | 30 | 40 | 8 | 0,276 |
| 40 ST10/22-2 | 40ST122 | 6F | FL027 | 22 | 70,03 | 68,15 | 75,0 | 52 | 30 | 40 | 8 | 0,337 |
| 40 ST10/24-2 | 40ST124 | 6F | FL029 | 24 | 76,39 | 74,55 | 83,0 | 58 | 30 | 40 | 8 | 0,392 |
| 40 ST10/25-2 | 40ST125 | 6F | FL029 | 25 | 79,58 | 77,70 | 83,0 | 60 | 30 | 40 | 8 | 0,422 |
| 40 ST10/26-2 | 40ST126 | 6F | FL031 | 26 | 82,76 | 80,90 | 87,0 | 60 | 30 | 40 | 8 | 0,477 |
| 40 ST10/27-2 | 40ST127 | 6F | FL032 | 27 | 85,95 | 84,10 | 91,0 | 60 | 30 | 40 | 8 | 0,536 |
| 40 ST10/28-2 | 40ST128 | 6F | FL033 | 28 | 89,12 | 87,25 | 93,0 | 60 | 30 | 40 | 8 | 0,540 |
| 40 ST10/30-2 | 40ST130 | 6F | FL035 | 30 | 95,49 | 93,65 | 97,0 | 60 | 30 | 40 | 8 | 0,640 |
| 40 ST10/32-2 | 40ST132 | 6F | FL038 | 32 | 101,86 | 100,00 | 106,0 | 65 | 30 | 40 | 10 | 0,693 |
| 40 ST10/36-2 | 40ST136 | 6F | FL043 | 36 | 114,59 | 112,75 | 119,0 | 70 | 30 | 40 | 10 | 0,873 |
| 40 ST10/40-2 | 40ST140 | 6F | FL047 | 40 | 127,32 | 125,45 | 131,0 | 80 | 30 | 40 | 10 | 1,067 |
| 40 ST10/44-0 | 40ST144 | 6 | - | 44 | 140,05 | 138,20 | - | 88 | 30 | 40 | 10 | 1,350 |
| 40 ST10/48-0 | 40ST148 | 6 | - | 48 | 152,78 | 150,95 | - | 95 | 30 | 40 | 16 | 1,516 |
| 40 ST10/60-0 | 40ST160 | 6 | - | 60 | 190,98 | 189,10 | - | 110 | 30 | 40 | 16 | 2,339 |

Pulegge per cinghie dentate passo metrico ST per cinghie "AT"
ST Timing belt pulleys metric pitch for "AT" belts
ST Zahnriemenscheiben metrische Teilung für "AT" Riemen
Poulies dentées ST pour courroies "AT" pas métrique
Poleas dentadas ST para correas "AT" con paso metrico

Materiale:
alluminio 6082 T6
UNI 9006/4 adatto al
trattamento anodico

Material:
aluminium 6082 T6
UNI 9006/4 suitable for
anodic treatment

Werkstoff:
Aluminium 6082 T6
UNI 9006/4 geeignet für
anodischen oxydation

Matière:
aluminium 6082 T6
UNI 9006/4 apte au
traitement anodique

Material:
aluminio 6082 T6
UNI 9006/4 apto para la
oxidacion anodica

Tipo / Type
6F

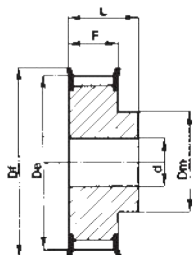

Tipo / Type
6

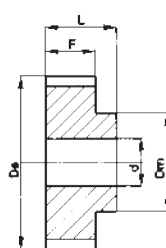

ST 10

(Passo 10 mm)
 per cinghia larghezza 32 mm

(Pitch 10 mm)
 for belt width 32 mm

(Teilung 10 mm)
 für Riemenbreite 32 mm

(Pas 10 mm)
 pour courroies largeur 32 mm

(Paso 10 mm)
 para correas ancho 32 mm

| Code Code symbol / Bezeichnung Code symbole / Numero de fabrica | Nostro codice Our code / Unser Code Notre code / Nuestro codigo | Tipo Type / Typ Type / Tipo | Code flangia Flange code / Bordscheiben Typ Code flasque / Código brida | N. denti N. of teeth / Zahnezahl N. bre de dents / Cantidad de dientes | Dp | De | Df | Dm | F | L | d | Peso / Weight Gewicht / Poids / Peso Kg |
|---|---|-----------------------------------|---|---|--------|--------|-------|-----|----|----|----|---|
| 47 ST10/18-2 | 47ST118 | 6F | FL021 | 18 | 57,29 | 55,45 | 60,0 | 40 | 37 | 47 | 10 | 0,253 |
| 47 ST10/19-2 | 47ST119 | 6F | FL024 | 19 | 60,48 | 58,60 | 66,5 | 44 | 37 | 47 | 10 | 0,286 |
| 47 ST10/20-2 | 47ST120 | 6F | FL024 | 20 | 63,66 | 61,80 | 66,5 | 46 | 37 | 47 | 12 | 0,322 |
| 47 ST10/22-2 | 47ST122 | 6F | FL027 | 22 | 70,03 | 68,15 | 75,0 | 52 | 37 | 47 | 12 | 0,393 |
| 47 ST10/24-2 | 47ST124 | 6F | FL029 | 24 | 76,39 | 74,55 | 83,0 | 58 | 37 | 47 | 12 | 0,475 |
| 47 ST10/25-2 | 47ST125 | 6F | FL029 | 25 | 79,58 | 77,70 | 83,0 | 60 | 37 | 47 | 12 | 0,527 |
| 47 ST10/26-2 | 47ST126 | 6F | FL031 | 26 | 82,76 | 80,90 | 87,0 | 60 | 37 | 47 | 12 | 0,564 |
| 47 ST10/27-2 | 47ST127 | 6F | FL032 | 27 | 85,95 | 84,10 | 91,0 | 60 | 37 | 47 | 12 | 0,602 |
| 47 ST10/28-2 | 47ST128 | 6F | FL033 | 28 | 89,12 | 87,25 | 93,0 | 60 | 37 | 47 | 12 | 0,642 |
| 47 ST10/30-2 | 47ST130 | 6F | FL035 | 30 | 95,49 | 93,65 | 97,0 | 60 | 37 | 47 | 12 | 0,740 |
| 47 ST10/32-2 | 47ST132 | 6F | FL038 | 32 | 101,86 | 100,00 | 106,0 | 65 | 37 | 47 | 12 | 0,844 |
| 47 ST10/36-2 | 47ST136 | 6F | FL043 | 36 | 114,59 | 112,75 | 119,0 | 70 | 37 | 47 | 16 | 1,063 |
| 47 ST10/40-2 | 47ST140 | 6F | FL047 | 40 | 127,32 | 125,45 | 131,0 | 80 | 37 | 47 | 16 | 1,317 |
| 47 ST10/44-0 | 47ST144 | 6 | - | 44 | 140,05 | 138,20 | - | 88 | 37 | 47 | 16 | 1,611 |
| 47 ST10/48-0 | 47ST148 | 6 | - | 48 | 152,78 | 150,95 | - | 95 | 37 | 47 | 16 | 1,931 |
| 47 ST10/60-0 | 47ST160 | 6 | - | 60 | 190,98 | 189,10 | - | 110 | 37 | 47 | 16 | 3,004 |

(Passo 10 mm)
 per cinghia larghezza 50 mm

(Pitch 10 mm)
 for belt width 50 mm

(Teilung 10 mm)
 für Riemenbreite 50 mm

(Pas 10 mm)
 pour courroies largeur 50 mm

(Paso 10 mm)
 para correas ancho 50 mm

| | | | | | | | | | | | | |
|--------------|---------|----|-------|----|--------|--------|-------|-----|----|----|----|-------|
| 66 ST10/18-2 | 66ST118 | 6F | FL021 | 18 | 57,29 | 55,45 | 60,0 | 40 | 56 | 66 | 10 | 0,422 |
| 66 ST10/19-2 | 66ST119 | 6F | FL024 | 19 | 60,48 | 58,60 | 66,5 | 44 | 56 | 66 | 10 | 0,466 |
| 66 ST10/20-2 | 66ST120 | 6F | FL024 | 20 | 63,66 | 61,80 | 66,5 | 46 | 56 | 66 | 12 | 0,520 |
| 66 ST10/22-2 | 66ST122 | 6F | FL027 | 22 | 70,03 | 68,15 | 75,0 | 52 | 56 | 66 | 12 | 0,570 |
| 66 ST10/24-2 | 66ST124 | 6F | FL029 | 24 | 76,39 | 74,55 | 83,0 | 58 | 56 | 66 | 12 | 0,736 |
| 66 ST10/25-2 | 66ST125 | 6F | FL029 | 25 | 79,58 | 77,70 | 83,0 | 60 | 56 | 66 | 12 | 0,766 |
| 66 ST10/26-2 | 66ST126 | 6F | FL031 | 26 | 82,76 | 80,90 | 87,0 | 60 | 56 | 66 | 12 | 0,816 |
| 66 ST10/27-2 | 66ST127 | 6F | FL032 | 27 | 85,95 | 84,10 | 91,0 | 60 | 56 | 66 | 12 | 0,946 |
| 66 ST10/28-2 | 66ST128 | 6F | FL033 | 28 | 89,12 | 87,25 | 93,0 | 60 | 56 | 66 | 12 | 0,960 |
| 66 ST10/30-2 | 66ST130 | 6F | FL035 | 30 | 95,49 | 93,65 | 97,0 | 60 | 56 | 66 | 12 | 1,169 |
| 66 ST10/32-2 | 66ST132 | 6F | FL038 | 32 | 101,86 | 100,00 | 106,0 | 65 | 56 | 66 | 12 | 1,300 |
| 66 ST10/36-2 | 66ST136 | 6F | FL043 | 36 | 114,59 | 112,75 | 119,0 | 70 | 56 | 66 | 16 | 1,637 |
| 66 ST10/40-2 | 66ST140 | 6F | FL047 | 40 | 127,32 | 125,45 | 131,0 | 80 | 56 | 66 | 16 | 1,999 |
| 66 ST10/44-0 | 66ST144 | 6 | - | 44 | 140,05 | 138,20 | - | 88 | 56 | 66 | 16 | 2,357 |
| 66 ST10/48-0 | 66ST148 | 6 | - | 48 | 152,78 | 150,95 | - | 95 | 56 | 66 | 16 | 2,830 |
| 66 ST10/60-0 | 66ST160 | 6 | - | 60 | 190,98 | 189,10 | - | 110 | 56 | 66 | 16 | 4,368 |

Barre dentate standard ST per cinghie " AT "
ST Standard toothed bars for " AT " belts
ST Standard Zahnriemenstangen für " AT "
Barreaux dentés standard ST pour courroies " AT "
Barras dentadas de serie ST para correas " AT "



Materiale:
alluminio 6082 T6
UNI 9006/4 adatto al
trattamento anodico

Material:
aluminium 6082 T6
UNI 9006/4 suitable for
anodic treatment

Werkstoff:
aluminium 6082 T6
UNI 9006/4 geeignet für
anodischen oxydation

Matière:
aluminium 6082 T6
UNI 9006/4 apte au
traitement anodique

Material:
aluminio 6082 T6
UNI 9006/4 apto para la
oxidacion anodica

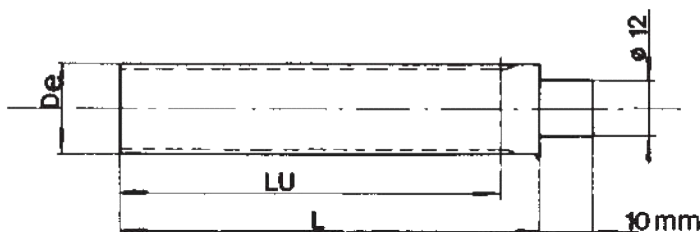

ST 5

(Passo 5 mm) / (Pitch 5 mm) / (Teilung 5 mm) / (Pas 5 mm) / (Paso 5 mm)

ST 10

(Passo 10 mm) / (Pitch 10 mm) / (Teilung 10 mm) / (Pas 10 mm) / (Paso 10 mm)

| Codice Code symbol Bezeichnung Code symbole Numero de fabrica | Nostro codice Our code Unser Code Notre code Nuestro codigo | N. denti N. of teeth Zähnezahl N. bre de dents Cantidad de dientes | De | Lu | L |
|---|---|---|--------|-----|-----|
| ST05012 | BST0512 | 12 | 17,85 | 125 | 140 |
| ST05013 | BST0513 | 13 | 19,45 | 125 | 140 |
| ST05014 | BST0514 | 14 | 21,05 | 132 | 140 |
| ST05015 | BST0515 | 15 | 22,65 | 132 | 140 |
| ST05016 | BST0516 | 16 | 24,20 | 140 | 140 |
| ST05017 | BST0517 | 17 | 25,80 | 140 | 140 |
| ST05018 | BST0518 | 18 | 27,40 | 140 | 140 |
| ST05019 | BST0519 | 19 | 29,00 | 140 | 140 |
| ST05020 | BST0520 | 20 | 30,60 | 160 | 160 |
| ST05021 | BST0521 | 21 | 32,30 | 160 | 160 |
| ST05022 | BST0522 | 22 | 33,85 | 160 | 160 |
| ST05023 | BST0523 | 23 | 35,45 | 160 | 160 |
| ST05024 | BST0524 | 24 | 37,00 | 160 | 160 |
| ST05025 | BST0525 | 25 | 38,60 | 160 | 160 |
| ST05026 | BST0526 | 26 | 40,20 | 160 | 160 |
| ST05027 | BST0527 | 27 | 41,80 | 160 | 160 |
| ST05028 | BST0528 | 28 | 43,35 | 160 | 160 |
| ST05029 | BST0529 | 29 | 44,95 | 160 | 160 |
| ST05030 | BST0530 | 30 | 46,55 | 160 | 160 |
| ST05031 | BST0531 | 31 | 48,15 | 160 | 160 |
| ST05032 | BST0532 | 32 | 49,70 | 160 | 160 |
| ST05033 | BST0533 | 33 | 51,30 | 160 | 160 |
| ST05034 | BST0534 | 34 | 52,85 | 160 | 160 |
| ST05035 | BST0535 | 35 | 54,45 | 160 | 160 |
| ST05036 | BST0536 | 36 | 56,05 | 160 | 160 |
| ST05038 | BST0538 | 38 | 59,25 | 160 | 160 |
| ST05040 | BST0540 | 40 | 62,45 | 160 | 160 |
| ST05042 | BST0542 | 42 | 65,60 | 160 | 160 |
| ST05044 | BST0544 | 44 | 68,80 | 160 | 160 |
| ST05045 | BST0545 | 45 | 70,40 | 160 | 160 |
| ST05046 | BST0546 | 46 | 72,00 | 160 | 160 |
| ST05048 | BST0548 | 48 | 75,15 | 160 | 160 |
| ST05050 | BST0550 | 50 | 78,35 | 160 | 160 |
| ST05052 | BST0552 | 52 | 81,55 | 160 | 160 |
| ST05054 | BST0554 | 54 | 84,70 | 160 | 160 |
| ST05055 | BST0555 | 55 | 86,30 | 160 | 160 |
| ST05056 | BST0556 | 56 | 87,90 | 160 | 160 |
| ST05058 | BST0558 | 58 | 91,10 | 160 | 160 |
| ST05060 | BST0560 | 60 | 94,25 | 160 | 160 |
| ST05062 | BST0562 | 62 | 97,45 | 160 | 160 |
| ST05064 | BST0564 | 64 | 100,65 | 160 | 160 |
| ST05065 | BST0565 | 65 | 102,25 | 160 | 160 |
| ST05070 | BST0570 | 70 | 110,20 | 160 | 160 |
| ST05072 | BST0572 | 72 | 113,25 | 160 | 160 |

| Codice Code symbol Bezeichnung Code symbole Numero de fabrica | Nostro codice Our code Unser Code Notre code Nuestro codigo | N. denti N. of teeth Zähnezahl N. bre de dents Cantidad de dientes | De | Lu | L |
|---|---|---|--------|-----|-----|
| ST10015 | BST1015 | 15 | 45,90 | 160 | 160 |
| ST10016 | BST1016 | 16 | 49,05 | 160 | 160 |
| ST10017 | BST1017 | 17 | 52,25 | 160 | 160 |
| ST10018 | BST1018 | 18 | 55,45 | 160 | 160 |
| ST10019 | BST1019 | 19 | 58,60 | 160 | 160 |
| ST10020 | BST1020 | 20 | 61,80 | 160 | 160 |
| ST10021 | BST1021 | 21 | 65,00 | 160 | 160 |
| ST10022 | BST1022 | 22 | 68,15 | 160 | 160 |
| ST10023 | BST1023 | 23 | 71,35 | 160 | 160 |
| ST10024 | BST1024 | 24 | 74,55 | 160 | 160 |
| ST10025 | BST1025 | 25 | 77,70 | 160 | 160 |
| ST10026 | BST1026 | 26 | 80,90 | 160 | 160 |
| ST10027 | BST1027 | 27 | 84,10 | 160 | 160 |
| ST10028 | BST1028 | 28 | 87,25 | 160 | 160 |
| ST10029 | BST1029 | 29 | 90,45 | 160 | 160 |
| ST10030 | BST1030 | 30 | 93,65 | 160 | 160 |
| ST10031 | BST1031 | 31 | 96,80 | 160 | 160 |
| ST10032 | BST1032 | 32 | 100,00 | 160 | 160 |
| ST10033 | BST1033 | 33 | 103,20 | 160 | 160 |
| ST10034 | BST1034 | 34 | 106,40 | 160 | 160 |
| ST10035 | BST1035 | 35 | 109,55 | 160 | 160 |
| ST10036 | BST1036 | 36 | 112,75 | 160 | 160 |
| ST10037 | BST1037 | 37 | 115,90 | 160 | 160 |
| ST10038 | BST1038 | 38 | 119,10 | 160 | 160 |
| ST10040 | BST1040 | 40 | 125,45 | 160 | 160 |
| ST10041 | BST1041 | 41 | 128,65 | 160 | 160 |
| ST10042 | BST1042 | 42 | 131,85 | 160 | 160 |
| ST10044 | BST1044 | 44 | 138,20 | 160 | 160 |
| ST10045 | BST1045 | 45 | 141,40 | 160 | 160 |
| ST48046 | BST1046 | 46 | 144,55 | 160 | 160 |
| ST10048 | BST1048 | 48 | 150,95 | 160 | 160 |
| ST10050 | BST1050 | 50 | 157,30 | 160 | 160 |
| ST10051 | BST1051 | 51 | 160,50 | 160 | 160 |
| ST10052 | BST1052 | 52 | 163,65 | 160 | 160 |
| ST10054 | BST1054 | 54 | 170,05 | 160 | 160 |
| ST10055 | BST1055 | 55 | 173,20 | 160 | 160 |
| ST10056 | BST1056 | 56 | 176,40 | 160 | 160 |
| ST10057 | BST1057 | 57 | 179,60 | 160 | 160 |
| ST10058 | BST1058 | 58 | 182,75 | 160 | 160 |
| ST10059 | BST1059 | 59 | 185,95 | 160 | 160 |
| ST10060 | BST1060 | 60 | 189,10 | 160 | 160 |
| ST10062 | BST1062 | 62 | 195,50 | 160 | 160 |
| ST10070 | BST1070 | 70 | 220,95 | 160 | 160 |
| ST10075 | BST1075 | 75 | 236,90 | 160 | 160 |

ÉKSZÍJ.HU